

SC0009 1132307Z

RR HQ

DE SC

R 282307Z APR 82

FM SACRAMENTO (100-8023)

TO DIRECTOR ROUTINE

BT

RECEIVED
TELETYPE UNIT

27 APR 82 21 10z

FEDERAL BUREAU
OF INVESTIGATION

mo

50450

Exec. AD-Adm.	_____
Exec. AD-Inv.	_____
Exec. AD-LES	_____
Asst. Dir.:	
Adm. Servs.	_____
Crim. Inv.	<i>CA</i>
Ident.	_____
Inspection	_____
Intell.	_____
Laboratory	_____
Legal Coun.	_____
Off. of Cong. & Public Affs.	_____
Rec. Mgnt.	_____
Tech. Servs.	_____
Training	_____
Telephone Ctr.	_____
Director's Sec'y	_____

UNCLAS

CALIFORNIA HOMEMAKERS ASSOC. (CHA); WESTERN SERVICE WORKERS ASSOC.

(WSPA); NATIONAL LABOR FEDERATION (NLF); DOMESTIC SECURITY. OO: SC.

RE SACRAMENTO TELETYPES DATED NOV. 9, 1981 AND JAN. 20, 1982.

RE BUTEL DATED JAN. 20, 1982.

FOBARRA

PRELIMINARY INQUIRY INITIATED OCT. 20, 1981, INITIAL EXPIRATION
JAN. 29, 1982, 90 DAY EXTENSION GRANTED TO APRIL 28, 1982.

SACRAMENTO JUST RECEIVED RESULTS OF TWO INTERVIEWS CONDUCTED
BY REDDING RA IN SACRAMENTO DIVISION CONCERNING CAPTIONED MATTER.

BASED ON INFORMATION OBTAINED AT SACRAMENTO CONCERNING
CAPTIONED GROUP, SACRAMENTO DOES NOT BELIEVE JUSTIFICATION EXISTS
WITHIN DOMESTIC SECURITY GUIDELINES TO CONTINUE INVESTIGATION.

100 - 486889 - 10

MAY 11 1982

Sp9 AG/dmj 9/18/95
**ALL INFORMATION CONTAINED
HEREIN IS UNCLASSIFIED
DATE 9/10/82 BY SP1GSK/9U**

[Redacted box]

[Redacted box]

b6
b7c

SIA

VAGE TWO SC 100-8023 UNCLAS

SACRAMENTO IS CONDUCTING NO FURTHER INVESTIGATION AND WILL
COMPILE COMPREHENSIVE LHM OF INVESTIGATION CONDUCTED.

BT

125
13
14

148

1 1

MAY 7, 1982

UNCLASSIFIED

PRIORITY

#F148PP SCDE HQ H0148 #HUYUP 072131Z MAY 82

Jmc

FM DIRECTOR FBI
TO FBI SACRAMENTO (100-8023) PRIORITY
BT

D

CRNK

UNCLAS

CALIFORNIA HOMEMAKERS ASSOC. (CHA); WESTERN SERVICE WORKERS ASSOC. (WSWA); NATIONAL LABOR FEDERATION (NLF); DOMESTIC SECURITY; 00: SACRAMENTO

REFERENCE SACRAMENTO TELETYPE TO BUREAU DATED APRIL 27,

See 10

1982.

PRELIMINARY INQUIRY EXPIRED APRIL 28, 1982.

SACRAMENTO SHOULD SUBMIT LHM IN CAPTIONED MATTER NO LATER THAN MAY 11, 1982.

BT

1

SP9 AG/dmr 9/18/95
**ALL INFORMATION CONTAINED
HEREIN IS UNCLASSIFIED
DATE 9/16/82 BY SPAGSK/gld**

(Handwritten signature/initials)

CPM/H

WJG:BAR (3) 5/7/82

4247 4650

1 - FIELD GUIDANCE DOMESTIC SECURITY

100-486889-11

1 -

MAY 11 1982

b6
b7C

FEDERAL BUREAU OF INVESTIGATION
COMMUNICATIONS CENTER

01372 mo
MAY 8 1982

68 JUN 08 1982

FBI

TRANSMIT VIA:

- Teletype
- Facsimile
- AIRTEL

PRECEDENCE:

- Immediate
- Priority
- Routine

CLASSIFICATION:

- TOP SECRET
- SECRET
- CONFIDENTIAL
- UNCLAS E F T O
- UNCLAS

ALL INFORMATION CONTAINED
HEREIN IS UNCLASSIFIED
DATE 9/18/95 BY SP9 AG/dmy

Date 5/14/82

TO: DIRECTOR, FBI

FROM: SAC, SACRAMENTO (100-8023) (C)

SUBJECT: CALIFORNIA HOMEMAKERS ASSOCIATION (CHA);
WESTERN SERVICE WORKERS ASSOCIATION (WSWA);
NATIONAL LABOR FEDERATION (NLF);
DOMESTIC SECURITY

OO: SC

Re SC teletypes, 11/9/81 and 1/20/82; Bureau teletype, 1/20/82; SC teletype, 2/11/82, captioned, "Unknown Group, Threat to Explode Thermo-Nuclear Device, Florida".

PII 10/30/81, extension granted, expired 4/28/82

Enclosed for FBIHQ are seven copies of LHM setting forth investigation conducted in this matter. Two of these LHMs are designated for Bureau file 174-9097.

Sacramento was not able to obtain further information concerning threat to explode Thermo-nuclear device, however in light of person advising of this matter having worked for a group which he stated as California Housing Association, it is being mentioned in conjunction with investigation of CHA.

Sacramento is of the opinion that investigation has not disclosed that captioned group presents a current threat to overthrow the government with violent means; nor is there sufficient information that group is being directed by foreign nation or organization.

- ⑤ - Bureau (Enc. 4) (RM)
(2 - 174-9097)
(1 - CI-3A)
- 1 - Sacramento
BRLK/ab
(6)

ENCLOSURE 100-486889-12
164247 & ATT
6-10-82 shk

b6
b7C

3 MAY 31 1982

Approved: 33

Transmitted _____

(Number)

(Time)

Per S&S

SC 100-8023

Sources referred to in LHM are as follows:

[redacted] telephone [redacted]

[redacted] California State Department
of Justice.

[redacted] Sacramento County Probation
Office.

b2
b6
b7C
b7D

[redacted]
[redacted]

[redacted]
[redacted]

[redacted]
[redacted]

[redacted]
[redacted] telephone [redacted]



U.S. Department of Justice

Federal Bureau of Investigation
Sacramento, California

In Reply, Please Refer to
File No.

May 14, 1982

CALIFORNIA HOMEMAKERS ASSOCIATION (CHA);
WESTERN SERVICE WORKERS ASSOCIATION (WSWA);
NATIONAL LABOR FEDERATION (NLF)

This investigation was predicated upon information resulting from a telephone call from [redacted] in which she advised that she had become a member of the California Homemakers Association (CHA) and this is a front for Communist activity towards the eventual overthrow of the United States government.

b2
b7D

On November 2, 1981, [redacted] was interviewed by FBI Agents. [redacted] advised that she believed this CHA was a self-help type organization that assisted people who were down and out. She since found out that CHA is a front for Communist activity and that the group has formulated plans for an overthrow of the United States government which is supposed to occur in approximately 27 months. She further stated that the CHA has two offices in Sacramento, California, the main office at 3500 Stockton Boulevard, and another office at 3714 Marysville Boulevard. She advised there is also another office in Redding, California, and that this office recently was busted for some kind of medical problem.

b2
b7D

[redacted] further stated that the organization is divided into approximately three levels. She states that the entry level is where the organization utilizes peoples' services on a volunteer basis to man different functions that are provided by the CHA. This phase is used as a testing ground for people to determine political orientation and suitability for movement to the next level. She stated that people in the entry level

ALL INFORMATION CONTAINED
HEREIN IS UNCLASSIFIED
DATE 9/18/95 BY SP9 AG/dmj

This document contains neither recommendations nor conclusions of the FBI. It is the property of the FBI and is loaned to your agency; it and its contents are not to be distributed outside your agency.

1 00 - 486889 - 12

ENCLOSURE

FBI/DOJ

CALIFORNIA HOMEMAKERS ASSOCIATION (CHA);

have no idea what the true purpose of the organization is. At the second level, candidates, or cadre members, are taken to training sessions in the Oakland, California area where they are indoctrinated more into the true purpose of the organization. The third level is the senior or planning and guidance level within the organization.

[redacted]
[redacted] She advised that she has since gotten accepted to the second level, and recently went to Oakland, California, to attend a higher level meeting of captioned organization, which was issued by invitation only, and which according to [redacted] occur every other Sunday at different locations in the Oakland area. [redacted] advised that she believes that this particular meeting was on the second Sunday in August, 1981. She stated that at this meeting there were three speakers, one from Cuba, one from Mexico, and one from Nicaragua, who she described as all being Communists. She stated that the Cuban individual was named [redacted] and that he wore a Cuban military uniform, consisting of beret, boots, and an olive drab type Cuban uniform.

b2
b6
b7C
b7D

[redacted] stated that especially concerning [redacted] he was brought in after all the people had been assembled and was escorted out of the meeting early so that no one was able to determine the nature or location of his departure.

b2
b6
b7C
b7D

[redacted] stated that they say the revolution will occur within 36 months, and that some of that time has elapsed. She stated that they say, "We knew there was going to be violence", so they were going to use it any way they could. She stated that regarding weapons, they said, "If they needed weapons, they already had them".

Some of captioned organization's documents refer to group as Western Service Workers Association (WSWA), CHA. The office at 3714 Marysville Boulevard has also received mail entitled, "Workers Community Service Center". Also leaflets for a group called "Coalition of Concerned Medical Professionals" are carried with the address 3714 Marysville Boulevard, Sacramento, California, telephone 925-0400.

[redacted] advises that the organization uses different names for different locations, and that the national name is

b2
b7D

CALIFORNIA HOMEMAKERS ASSOCIATION (CHA);

"National Labor Federation" (NLF). On the East Coast of the United States they use Eastern Farmworkers Association (EFA).

[redacted] advised that the following individuals are leaders:

[redacted]
[redacted] advised that there is a Marx-Engels reader available to those people in level two and that is marked with what should be read. She advised that important documents are kept at members' houses. she knows for a fact that there are important documents at [redacted] house. [redacted] stated there are probably about 30 people at the cadre or level three, and that these people meet secretly at different locations.

b2
b6
b7C
b7D

The people at the level three are also referred to as ops, which is short for operations, and that one of the Sacramento heads, [redacted] recently was transferred to another division.

b2
b6
b7C
b7D

[redacted] stated that she heard the comment made, "The FBI thought they were smart. We're smarter than they'll ever get to be".

On January 6, 1982, [redacted] was recontacted for further information concerning [redacted] as well as additional information available to her regarding captioned organization.

b2
b6
b7C
b7D

[redacted] described [redacted] who was mentioned as having been at the CHA meeting in Oakland, California, wearing a Cuban military uniform, as being a Latin male, [redacted]

[redacted]
[redacted] said she would be able to identify if she was to see a photograph. She further advised that this individual did carry a gun, which she described as a machine gun type with a shoulder strap, and after looking at several pictures of guns, said it most closely resembled an M-2 paratrooper carbine. She said he was wearing a black beret and black paratrooper boots.

b2
b6
b7C
b7D

[redacted] also advised that there is now a person in the Sacramento area who is from South Africa, his name is [redacted] (phonetic), last name unknown, and he is described as a black

CALIFORNIA HOMEMAKERS ASSOCIATION (CHA);

male, [redacted] She advised that he is anti-South African government and speaks favorably about the Southwest African Peoples Organization (SWAPO). She described [redacted]

b6
b7C

[redacted]
[redacted]

She advised that he is a student in Sacramento and is here for the purpose of learning the skills of organizing, such as those available at CHA, to take back to South Africa.

Additional information provided by [redacted] on January 6, 1982, included a recent large meeting held at California State University at Sacramento (CSUS), which was approximately two weeks ago on a Sunday. Those who had an influential part in this meeting were a Sacramento attorney named [redacted]

b2
b6
b7C
b7D

[redacted] advised that there is some kind of a headquarters of NLF in Suffolk County, New York.

[redacted] stated that [redacted] who she earlier mentioned, left Sacramento approximately one year ago. She advised she saw [redacted]

b2
b6
b7C
b7D

[redacted] advised another leader of the Sacramento area who disappeared to an unknown location is [redacted]

[redacted] advised that she remembers [redacted] saying, "If they want force, we have it, our Army is prepared. If it takes ammunition, we have it".

b2
b6
b7C
b7D

[redacted] advised that at the meetings, such as the one at Oakland and CSUS, they have two guards posted as security outside the building, and two guards inside the building. She advised that to her knowledge, they were not armed, however they do wear coats even when the weather is warm. She said that they do not let them know where a meeting is to be held until such time as they are leaving to go to the meeting. She was disturbed at this as she was not able to leave a contact

CALIFORNIA HOMEMAKERS ASSOCIATION (CHA);

number for a babysitter. She said there were from 300-400 people at these meetings.

On January 13, 1982, [redacted] an investigator for a local law enforcement agency, advised that their agency has conducted an investigation regarding captioned group concerning illegal drug prescriptions and other safety and health statutes. [redacted] advised that their investigation was close to conclusion and no violations were apparent.

b2
b7D

[redacted] provided a name of an individual, who will be referred to in this communication as [redacted] who mentioned observing CHA members with M-16 rifles in June of 1979 at Santa Cruz, California. [redacted] appeared to be somewhat doubtful as to the veracity of this information.

On February 22, 1982, [redacted] a person in a position to know, due to his employment, advised he is doing a pre-sentence report on [redacted] who stated that his wife, [redacted] was involved with captioned organization. [redacted] told [redacted] he is trying to get his wife out of town away from the group. [redacted] did not think that [redacted] would be willing to talk to authorities concerning the organization. [redacted] told [redacted] that the group is a subversive group which advocates the violent overthrow of the United States government.

b2
b6
b7C
b7D

On March 3, 1982, [redacted] called the Sacramento FBI Office and advised that the CHA is a subversive organization. He advised that he and [redacted] just joined and he believes it is Communist. [redacted] advised he did not have a telephone. Attempts to locate and interview [redacted] were negative.

b2
b6
b7C
b7D

[redacted] advised that it had been some time since he had any contact with the WSWA. He stated that he is not knowledgeable about any specific activities and is not aware of any foreign control. He characterized this group as more violence prone than the Ku Klux Klan and described them as scavengers, waiting for things to go down so that they can move in.

[redacted] advised that [redacted] the Legal Services of Northern California. [redacted] stated that when she first came to Redding, California, she had been

b2
b6
b7C
b7D

CALIFORNIA HOMEMAKERS ASSOCIATION (CHA);

contacted by WSWA and requested to do volunteer work for them. She said that because of her association with doctors and pharmacists, she had been placed on a telephone to do solicitation calling requesting free medical services and free medicine to the "poor". She stated that after she had attended a couple of meetings, which she characterized as very radical in language,

b6
b7C
b7D

[redacted] She described them as individuals who want to protest everything and to demonstrate. They are very anti-establishment and she felt that they used mind control on low income people. They would provide information to the poor which the poor would relate to, and then continue to convince them to see things the way the WSWA wanted them to believe.

Several months ago the Shasta County Sheriff's Office, acting on a search warrant, confiscated many of the drugs which the association was using. Following this raid, [redacted] stated that she had been contacted by workers of the association and threatened if she testified against them, they would do her bodily harm. She claimed to have been followed in vehicles and by individuals and to have been harassed by them.

b2
b7D

She stated that she had not been allowed to see any of the documentation for the organization, but estimated that there were approximately 150 in Shasta County who were active two years ago. She stated that probably there were no more than ten leaders of the group.

[redacted] stated that in the main office in Redding, California, there is a locked room with some rifles and a "drawer full" of hand guns.

b2
b7D

[redacted] was aware of branches of the association in Santa Cruz County, Berkeley, Sacramento County, and she heard they were starting up last December in Fresno and Merced, California. The group has a common direction and she was aware of one Iranian on the board in Shasta County who travels all over the state. In addition to the names used by the group in the title of this case, she advised they also use the organization Hospital and Medical Personnel Association. These names are used depending on who the group is talking to. When a doctor is approached it is in the name of the Hospital and Medical Personnel Association and when a lawyer is approached, it would be under the WSWA name. Her description of the group was that they were "very Third World". They talk about taking over the establishment and their dogma is to promote anger against the establishment or the rich. They do not trust anyone in the establishment.

CALIFORNIA HOMEMAKERS ASSOCIATION (CHA);

Normal wear for the leaders of the group are blue jeans, an olive drab shirt and a blue sweatshirt with a zipper and hood. This seems to be a uniform for the leaders in the organization.

In Shasta County, someone in the Welfare Department is providing information to WSWA. Any families who have been cut off welfare are immediately approached for recruiting by the association.

[redacted] advised that they charge weekly dues of 62 cents per week. She felt there had to be some outside source of funds, but had no knowledge of foreign funds or where any funds would come from. The group actively recruits individuals who are mentally retarded or are on assistance from SSI, and then persuade them to sign their checks over to WSWA in return for being "taken care of" by the organization.

b2
b7D

In February, 1982, [redacted] U. S. Army reserve, assigned to a military intelligence unit, advised Sacramento FBI of some information that was relayed to him by a person described as [redacted] last name unknown. This information is provided with information concerning captioned organization because of the fact that [redacted] explained that he had been volunteering as a canvasser for the California Housing Association. There is no other information to show a connection between information provided by [redacted] and captioned organization, and Sacramento is setting this information forth with this in mind.

b2
b6
b7C
b7D

[redacted] advised that [redacted] and engaged [redacted] in a conversation at the Weatherstone Coffee House in Sacramento, California. Referring to a conversation that [redacted] had about six months ago, [redacted] stated that, "You're right, there are foreign agents involved in some of the liberal groups". [redacted] asked him what he meant and he explained as follows:

b2
b6
b7C
b7D

(1) He had been volunteering as a canvasser for the California Housing Association, an Hispanic neighborhood group, and a no-nuke group.

(2) He said there are several "professional organizers trained in Cuba" who are involved in these and other groups, "which he did not identify". He described them as highly motivated,

CALIFORNIA HOMEMAKERS ASSOCIATION (CHA);

very disciplined, and that they "worked 18 hours a day".

(3) For the first time he became aware of them at a meeting which took place in Sacramento, California (not further described).

(4) He said they talked about "importing a thermo-nuclear device". He did not know from where, and he said that he did not think they were too serious about this proposal.

(5) He said that they also mentioned "an operation in Florida". He explained a small group was planning to go to Florida and blow something up with either a "thermite or a regular explosive". He said they were planning to make the explosion look like a "right wing group did it". He mentioned an anti-Castro group and a pro-El Salvadorean government group as the possible groups to blame it on. In this regard, he mentioned they had the appropriate "uniforms" to make it look like they (the right wing group in question) did it. [redacted] said they talked very seriously about it and he believed them.

b2
b6
b7C
b7D

[redacted] described [redacted] as a very bright caucasian of about [redacted]

[redacted]
[redacted]
a nice person and was quite frightened about what he recently learned about "professional agents" operating in these groups.

[redacted] advised he would contact the FBI if he obtained any more information or if he again saw [redacted] so that Sacramento could identify [redacted]

b2
b6
b7C
b7D

95 0

*we had
AK
AW*

1 2

4/19/82

UNCLAS

ROUTINE

g

#F095ERR NK NY PHIDE HQ #0095 #H4YUUR 192120Z APR 82
FM DIRECTOR FBI
TO FBI PHILADELPHIA ROUTINE
FBI NEWARK ROUTINE
FBI NEW YORK ROUTINE
BT

3

ALL INFORMATION CONTAINED
HEREIN IS UNCLASSIFIED
DATE 9/18/95 BY SP9 AG/dmj

[Handwritten mark]

UNCLAS

EASTERN SERVICE WORKERS ASSOCIATION (ESWA) NATIONAL LABOR
FEDERATION (NLF); DOMESTIC SECURITY: 00: PHILADELPHIA.

NEW YORK AIRTEL TO THE BUREAU DATED JANUARY 11, 1982,
BUREAU AIRTEL TO NEW YORK DATED FEBRUARY 17, 1982, NEWARK
AIRTEL TO THE BUREAU DATED APRIL 9, 1982. THE ABOVE REFERENCES
ARE CAPTIONED ESWA/NLF; FCI-R (CPUSA) 00: NEW YORK.
PHILADELPHIA AIRTEL TO THE BUREAU DATED APRIL 12, 1982.

LIMITED INVESTIGATION AUTHORIZED APRIL 12, 1982, TO
EXPIRE JULY 11, 1982.

PHILADELPHIA WILL SERVE AS OFFICE OF ORIGIN IN THIS
LIMITED INVESTIGATION WHICH HAS BEEN OPENED TO DETERMINE,

[Handwritten initials]

[Handwritten initials]

CPM/A

WJG/CAA (4)

4/19/82

4247

4650

b6
b7c

1 -
1 -
1 - FIELD GUIDANCE D/S

105-273233

100-486889-13

[Handwritten stamp]

SEARCHED INDEXED SERIALIZED FILED

APR 22 1982

33

2

PAGE TWO DEH**DE HQ H0095 UNCLAS
UNDER ATTORNEY GENERAL GUIDLINES FOR DOMESTIC SECURITY
INVESTIGATIONS, WHETHER SUFFICIENT PROBABLE CAUSE EXISTS TO
CONVERT THIS MATTER TO A FULL FIELD DOMESTIC SECURITY
INVESTIGATION.

NEW YORK AND NEWARK SHOULD PROVIDE RESULTS OF ALL
INVESTIGATIONS REGARDING CAPTIONED MATTER NOT PREVIOUSLY
PROVIDED TO PHILADELPHIA IN SUFFICIENT TIME TO ALLOW
PHILADELPHIA TO PREPARE A COMPREHENSIVE LETTER HEAD MEMORANDUM
TO ARRIVE AT THE BUREAU ON OR BEFORE JULY 11, 1982. IT IS
REQUESTED IN ORDER TO MEET THIS DEADLINE THAT NEWARK AND
NEW YORK PROVIDE THEIR INFORMATION TO PHILADELPHIA NO LATER
THAN JUNE 18, 1982.

PHILADELPHIA'S SUBMISSION SHOULD INCLUDE RECOMMENDATIONS
REGARDING FURTHER INVESTIGATION OF THIS MATTER.

BT

1

NOTE: THIS DOMESTIC SECURITY LIMITED INVESTIGATION IS PREDICATED ON A PREVIOUS INVESTIGATION OF THE CAPTIONED SUBJECT UNDER THE FCI GUIDELINES, TO DETERMINE WHETHER ESWA WAS AN ORGANIZATION SERVING AS A FRONT FOR THE CPUSA. INVESTIGATION CONDUCTED BY NK, PH AND NY COULD SHOW NO POSITIVE LINK BETWEEN THE CPUSA AND THE ESWA AND ACCORDINGLY A LIMITED DOMESTIC SECURITY INVESTIGATION IS BEING OPENED.

NY0252 1470254

RECEIVED
TELETYPE UNIT

26 MAY 82 0754

FEDERAL BUREAU
OF INVESTIGATION

Exec. AD-Adm.	_____
Exec. AD-Inv.	_____
Exec. AD-LES	_____
Asst. Dir.:	
Adm. Servs.	_____
Crim. Inv.	_____
Ident.	_____
Inspection	_____
Intell.	_____
Laboratory	_____
Legal Coun.	_____
Off. of Cong. & Public Affs.	_____
Rec. Mgmt.	_____
Tech. Servs.	_____
Training	_____
Telephone Rm.	_____
Director's Sec'y	_____

RR HQ NK PH
DE NY 036
R 252300 MAY 82

FM NEW YORK (229B-87) (C) (JTF-2)
TO DIRECTOR ROUTINE
NEWARK ROUTINE
PHILADELPHIA ROUTINE

ALL INFORMATION CONTAINED
HEREIN IS UNCLASSIFIED
DATE 9/18/95 BY SP9AG/dmj

JONES

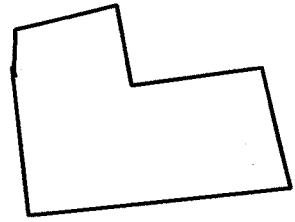

BT

UNCLAS

EASTERN SERVICE WORKERS ASSOCIATION (ESWA) NATIONAL LABOR FEDERATION

b6
b7C

(NLF); DOMESTIC SECURITY; OO: PHILADELPHIA.

REBUREAU TEL TO PHILADELPHIA, NEWARK AND NEW YORK, DATED
APRIL 19, 1982.

JM

PHILADELPHIA HAS ALREADY RECEIVED ALL INVESTIGATIVE RESULTS
FROM NEW YORK CONCERNING CAPTIONED MATTER. NEW YORK IS CONDUCTING
NO FURTHER INVESTIGATION IN THIS MATTER.

100-486889-14

BT

~~105-293232~~

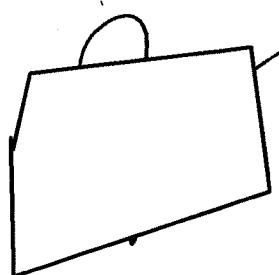

b6
b7C

#

[Handwritten signature]

JUN 11 1982

FBI

TRANSMIT VIA:

- Teletype
- Facsimile
- AIRTEL

PRECEDENCE:

- Immediate
- Priority
- Routine

CLASSIFICATION:

- TOP SECRET
- SECRET
- CONFIDENTIAL
- UNCLAS E F T O
- UNCLAS

Date 6/4/82

TO: DIRECTOR, FBI

FROM: SAC, NEWARK (100-57407) (RUC) (FCI-1)

~~EASTERN SERVICE WORKER'S ASSOCIATION (ESWA)/~~
~~NATIONAL LABOR FEDERATION (NLF);~~
 DOMESTIC SECURITY
 OO: PHILADELPHIA

DECLASSIFIED BY SP9AG/lonj
 ON 9/18/95

This communication is classified "Secret" in its entirety unless otherwise indicated.

Re: Bureau teletype to Philadelphia, dated 4/19/82.
 Philadelphia airtel to the Bureau, dated 4/12/82.

Limited investigation authorized 4/12/82, to expire 7/11/82.

Philadelphia Division has been provided with all information available to Newark at this time, with the following exception:

On 4/26 and 4/28/82, an anonymous caller contacted the Piscataway Resident Agency and provided the following information regarding captioned organization. It is noted however that while the caller's identity is not known, during the initial telephone message on 4/26/82,

~~SECRET~~
 CLASSIFIED AND EXTENDED BY: 3366
 REASONS FOR EXTENSION FCIM, II, 1-2.4.2: 2&3
 DATE OF REVIEW FOR DECLASSIFICATION: 6/4/2002

- 2 - Bureau
- 2 - Philadelphia
- 1 - Newark
- JDL/tcw
- (5)

JUN 11 1982

b6
 b7C

Approved: [Signature] Transmitted _____ (Number) _____ (Time) Per [Signature]

NK 100-57407

the anonymous caller requested the lead agent in PIRA by name.

The caller stated that he had learned of captioned organization through a friend who holds membership in that organization. He stated however, that he has on occasion "sat in on" meetings of that group in New Brunswick, N.J. These would be attended by approximately 10 to 15 people. Only first names were used during these meetings.

The caller stated that this organization does succeed in obtaining donations from a variety of individuals. Some of these donations are used to help poor people who have material needs. In this regard ESWA is in contact with prominent individuals such as doctors and attorneys. The caller advised that ESWA frequently receives individuals who are in financial need as referrals from the local welfare office. The above mentioned acquaintance of the caller who is an active ESWA member, was one such referral. This individual reportedly received a book concerning Karl Marx from ESWA officials.

The caller went on to describe this organization as "100% communist" and has learned that ESWA is planning "something big" within the next 24 months. The caller does not know what is meant by "something big". The caller stated that he has heard this statement made himself at ESWA meetings and has heard unspecified individuals state "We are going to take over". The caller denied having knowledge of any plans for "taking over" or for violence.in this regard.

The caller was unable or unwilling to provide last names of individuals he had met through ESWA, however, did provide the following descriptive data on four individuals who were described as leaders of the New Brunswick, N.J., chapter:

Name	<input type="text"/> LNU
Race	White
Sex	Male
Ethnic	<input type="text"/>
Age	<input type="text"/>
Height	<input type="text"/>
Hair	<input type="text"/>
Build	<input type="text"/>

b6
b7C

NK 100-57407

The caller advised that [redacted] LNU also [redacted]
[redacted] and was described as being
[redacted]

b6
b7C

Name [redacted] LNU
Race White
Sex Female
Age [redacted]
Hair [redacted]
Build [redacted]
Miscellaneous [redacted]

[redacted] LNU
White
Female
[redacted]

b6
b7C

Name [redacted] LNU
Race White
Sex Female
Age [redacted]
Hair [redacted]
Miscellaneous [redacted]

[redacted] LNU
White
Female
[redacted]

b6
b7C

Name [redacted] LNU
Race White
Sex Male
Age [redacted]
Height [redacted]
Build [redacted]
Hair [redacted]

[redacted] LNU
White
Male
[redacted]

The caller advised that [redacted] LNU is [redacted]
and that he is constantly active in performing tasks of the
ESWA organization.

Asset stated that individuals from ESWA chapters
in various cities across U.S. held a meeting on 5/2/82, at an
unknown location in Bronx, N.Y. The caller advised that he
has learned from his acquaintance, who is a member of ESWA,
that these meetings which are held periodically are normally
all day affairs. He was told further that uniformed armed
guards control access to these meetings.

b6
b7C

The anonymous caller went to advise that on at
least one occasion he heard [redacted] LNU state "We have greater
control in this country than people realize".

~~SECRET~~

NK 100-57407

No additional information is available regarding captioned organization at this time.

~~SECRET~~

4*

102

ST
A
B
C

1 of 2

JULY 1, 1982

CLASSIFICATION
UNCLASSIFIED

PRECEDENCE
PRIORITY

*F102*PP PHIDE HQ #0102 *HUYUP 012024Z JUL 82

CR

FM DIRECTOR FBI

TO FBI PHILADELPHIA (PH) PRIORITY

BT

3 RW

UNCLAS

EASTERN SERVICE WORKER'S ASSOCIATION (ESWA), NATIONAL LABOR

FEDERATION (NLF), DOMESTIC SECURITY; 00: PH

REFERENCE BUREAU TELETYPE TO PH DATED APRIL 19, 1982.

LIMITED DOMESTIC SECURITY INVESTIGATION INITIATED APRIL 12, 1982, TO EXPIRE JULY 11, 1982.

PH SHOULD IMMEDIATELY SUTEL DATE WHEN LHM WILL ARRIVE

FBIHQ REGARDING CAPTIONED MATTER ADVISING RECOMMENDATION TO

CLOSE, EXTEND, OR UPGRADE THE INVESTIGATION. 100486889-16

PH IS REMINDED OF THE NEED TO ADHERE TO PRESCRIBED DEAD-LINES ON DOMESTIC SECURITY INVESTIGATIONS AS SET FORTH IN SECTION 100 OF THE MANUAL OF INVESTIGATIVE OPERATIONS AND

GUIDELINES.

BT

ALL INFORMATION CONTAINED
HEREIN IS UNCLASSIFIED
DATE 9/18/95 BY SP9AG/dmj

~~105-292232-25~~

JUL 2 1982

APPROVED BY

OBR 18

CLASSIFIED BY

LLS:BAR (5)

DATE

7/1/82

ROOM

4247

EXTENSION

4650

b6
b7C

1 - [redacted]
2 - [redacted]

1 - FIELD GUIDANCE FOLDER/DOMESTIC SECURITY

1886

FEDERAL BUREAU OF INVESTIGATION
COMMUNICATIONS SECTION
060924
JUL 2 1982

UNRECORDED COPY FILED IN 100-486889-16
DESTROYED 9/18/95

PH0011 1832207Z

RR HQ

DE PE

R 022207Z JUL 82

FM PHILADELPHIA (100-56279) (SQ12) (P)

TO DIRECTOR ROUTINE

BT

UNCLAS

RECEIVED
TELETYPE UNIT

7 JUL 82 22 10z

FEDERAL BUREAU
OF INVESTIGATION

Exec. AD-A	_____
Exec. AD-B	_____
Exec. AD-LL	_____
Asst. Dir.:	
Adm. S.	_____
Crim.	_____
Ident.	_____
Inspection	_____
Intell.	_____
Laboratory	_____
Legal Coun.	_____
Off. of Cong. & Public Affs.	_____
Rec. Mgnt.	_____
Tech. Servs.	_____
Training	_____
Telephone Rm.	_____
Director's Sec'y	_____

30

b6
b7C

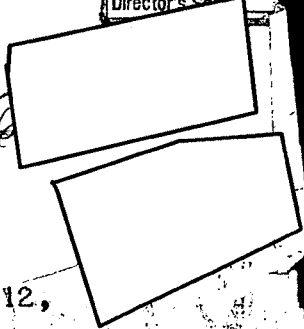

EM

EASTERN SERVICE WORKER'S ASSOCIATION (ESWA), NATIONAL LABOR
FEDERATION (NLF), DOMESTIC SECURITY; 00:PH

RE BUREAU TELETYPE TO PHILADELPHIA, JUNE 1, 1982.

LIMITED DOMESTIC SECURITY INVESTIGATION INITIATED APRIL 12,
1982, TO EXPIRE JULY 11, 1982.

DETAILED LHM WILL ARRIVE AT FBIHQ BY JULY 7, 1982, WITH
RECOMMENDATION TO EXTEND LIMITED INVESTIGATION ON A UACB BASIS

BT

1004247

ALL INFORMATION CONTAINED
HEREIN IS UNCLASSIFIED
DATE 9/18/95 BY SP9AG/dmj

X

~~100-486889-17~~

~~105-243032~~

TO JUL 8 1982

22

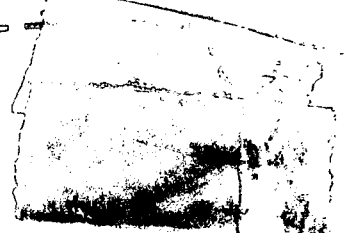

FBI

TRANSMIT VIA:

- Teletype
- Facsimile
- AIRTEL

PRECEDENCE:

- Immediate
- Priority
- Routine

CLASSIFICATION:

- TOP SECRET
- SECRET
- CONFIDENTIAL
- UNCLAS E F T O
- UNCLAS

Date 7/7/82

TO: DIRECTOR, FBI

FROM: SAC, PHILADELPHIA (100-56279) (SQ12) (P)

SUBJECT: EASTERN SERVICE WORKERS ASSOCIATION (ESWA) /
NATIONAL LABOR FEDERATION (NLF) /
 DOMESTIC SECURITY
 (OO:PH)

Re Bureau teletype to Philadelphia 7/1/81.
 Philadelphia airtel and LHM to Bureau 4/12/82.

Enclosed for the Bureau are six copies of an LHM
 and for Newark and New York, one copy for information purposes:

Limited Domestic Security Investigation initiated
 4/12/82, to expire 7/11/82.

Investigation conducted by the Philadelphia Division
 during this limited investigation time period tends to verify
 information previously furnished to the Bureau in referenced
 Philadelphia airtel and LHM, and that furnished by the New York
 and Newark Divisions. It should be noted that both Newark and
 New York, have closed their cases on captioned organization.
 Philadelphia has been unable to obtain any information on any

- ③ - Bureau (Encl. 6)
- 1 - TRAC
- 1 - Newark (100-57407) (Encl. 1)
- 1 - New York (229B-87) (Encl. 1)
- 2 - Philadelphia (100-56279) (SQ12)

DLJ:lap
 (7)

ALL INFORMATION CONTAINED
 HEREIN IS UNCLASSIFIED
 DATE 9/18/95 BY SP9 AG/dmy

7 JUL 12 1982

Approved: *[Signature]*

Transmitted _____

(Number)

(Time)

Per _____

JUL 16 1982

violent type activities planned by captioned organization, or any specific information regarding their planned overthrow of the U. S. Government; however, all discussions of violence have originated in New York.

Philadelphia is requesting a 90 day extension of this limited investigation of captioned organization and UACB limited investigation will expire 10/8/82.

The reason for the extension is to enable Philadelphia to conduct the following investigation:

1. Contact previously established informant to attend group meetings who has recently been invited to serve on advisory committee of ESWA.

2. Contact the Philadelphia Police Department who is conducting an investigation on ESWA, and who recently have interviewed the owner of 1518 South Street, headquarters of Philadelphia ESWA.

3. Conduct further established source checks to determine if any relationships exists between the ESWA and any violence prone groups.



U.S. Department of Justice

Federal Bureau of Investigation

In Reply, Please Refer to
File No.

Philadelphia, Pennsylvania

July 8, 1982

ALL INFORMATION CONTAINED
HEREIN IS UNCLASSIFIED
DATE 9/18/95 BY SP9AG/dmy

EASTERN SERVICE WORKERS' ASSOCIATION
NATIONAL LABOR FEDERATION;
DOMESTIC SECURITY

Extension of limited investigation.

Preliminary investigations were previously conducted by the New York and Newark Offices of the Federal Bureau of Investigation (FBI) because of allegations that the Eastern Service Workers' Association (ESWA)/National Labor Federation (NLF) has been connected with the Communist Part of the United States of America (CPUSA). Investigation determined that ESWA/NLF is not part of the CPUSA, but as a result of those preliminary investigations, serious questions were raised concerning the potential for violence by the ESWA/NLF.

During the course of a limited domestic security investigation on the ESWA/NLF, the Philadelphia Office of the FBI has obtained the following information:

The Philadelphia Chapter of the ESWA/NLF is currently located at 1518 South Street, Philadelphia, Pa., telephone number (215) 545-9055. This is the official number which is published in the Philadelphia White Pages Telephone Directory. A previous office located at 1701 North 42nd Street, Philadelphia, Pa., was recently closed. The property located at 1518 South Street is

The Philadelphia Chapter is currently under eviction notice from [redacted] as they owe \$1,000 in back rent. They are currently attempting to solicit contributions from various Philadelphia City Council members and State Representatives to cover their rent. The ESWA is also attempting to organize another branch in the North Philadelphia area of the city.

This document contains neither recommendations nor conclusions of the FBI. It is the property of the FBI and is loaned to your agency; it and its contents are not to be distributed outside your agency.

100-486889-18
105-1293232-24

ENCLOSURE

b6
b7C

EASTERN SERVICE WORKERS' ASSOCIATION

The organization has offices located in Atlantic City, Trenton, and New Brunswick, N.J. Additionally, offices are located in Long Island, N.Y.

The ESWA is an organization oriented towards providing social reform and assistance programs for the poor. They claim to provide emergency housing, dental care, and food programs. They additionally claim to provide legal aid and medical care for the poor. Classes are held at 1518 South Street relating to obtaining public housing and public assistance problems. These programs are paid for by soliciting for contributions on street corners, and through contacts with city officials for donations to help the poor.

A review of the Commonwealth of Pennsylvania Corporation Bureau Records reflected no information on ESWA/NLF.

The Philadelphia Chapter is composed of the following members:

[redacted]
Date of Birth (DOB) [redacted]
Previous address: [redacted]

b6
b7C

[redacted] full-time staff member and [redacted]
DOB [redacted]
Previous address [redacted]

[redacted]
DOB [redacted]
Previous address [redacted]

b6
b7C

[redacted] also known as [redacted]

Review of the records of the Philadelphia Office of the FBI contain no information on the above individuals. In addition, a review of the records of the City of Philadelphia reveal none of the above individuals own a firearm, or has a previous arrest record. Investigation has determined that [redacted] all live [redacted] 1518 South Street.

b6
b7C

EASTERN SERVICE WORKERS' ASSOCIATION

The Philadelphia Chapter appears to have about nine full-time members, and claims to have over 3000 members nationwide. The purpose of the ESWA appears to be oriented to providing emergency care to the poor; however, also conduct speaking engagements in churches and workshops at their office, where they discuss creating changes in the U. S. Government. Indoc-trination classes continue to be held at an unknown location in New York City on communist ideology with emphasis on Chinese and Cuban communism. These classes are conducted under military guard. Classes are also held at the National Labor Federation College in North Jersey.

The leaders continue to mention they have a 24 month timetable for the overthrow of the U. S. Government, and expect the overthrow to occur by the poor people, similar to the Bolshevik Revolution in the Soviet Union. No specific actions are known; however, there has been discussion that several members have been involved in para-military training. Attempts to determine specific plans for the violent overthrow of the U.S. Government were met by the leaders that this was a closed matter, and not open for discussion.

Philadelphia has no information at this time that would indicate the ESWA is connected with any other domestic group. Investigation has also determined that the ESWA did not participate in any demonstrations with the Democratic National Conference held in Philadelphia, Pa., from June 25 - 27, 1982.

On April 26 and April 28, 1982, an anonymous caller contacted the Newark Office of the FBI, and stated as follows:

The caller stated that he had learned of the ESWA through a friend who holds membership in the organization. He stated, however, that he has on occasion "sat in on" meetings of that group in New Brunswick, N.J. These would be attended by approximately 10 to 15 people. Only first names were used during these meetings.

The caller stated that this organization does succeed in obtaining donations from a variety of individuals. Some of these donations are used to help poor people who have material needs. In this regard, ESWA is in contact with prominent individuals such as doctors and attorneys. The ESWA frequently receives individuals who are in financial need from the local welfare office.

EASTERN SERVICE WORKERS' ASSOCIATION

The caller went on to describe this organization as "100 percent communist", and has learned that ESWA is planning "something big" within the next 24 months. The caller does not know what is meant by "something big". The caller stated that he has heard unspecified individuals state, "We are going to take over." The caller denied having knowledge of any plans for "taking over", or for violence in this regard.

The caller stated that individuals from ESWA Chapters in various cities across the U. S. held a meeting on May 2, 1982, at an unknown location in Bronx, N.Y. The caller advised that he has learned from his acquaintance, who is an ESWA member, that these meetings which are held periodically are normally all day affairs. He was further told that uniformed armed guards control access to these meetings.

The caller went on to advise that on at least one occasion, and ESWA member said, "We have greater control in this country than people realize".

An extension of this limited investigation is required to determine if the ESWA has the potential to commit acts of violence, and to determine if any relationship exists between any known violence prone groups and the ESWA.

0006 2792145Z

RR HQ

DE PH

R 062145Z OCT 82

FM PHILADELPHIA (100-56279) (SQ12) (P)

TO DIRECTOR ROUTINE INVESTIGATION

BT

UNCLAS

RECEIVED TELETYPE UNIT

5 OCT 82 07z

FEDERAL BUREAU OF INVESTIGATION

3
4

Exec. AD-Adm.	_____
Exec. AD-Inv.	_____
Exec. AD-LES	_____
Asst. Dir.:	
Adm. Servs.	_____
Crim. Inv.	_____
Ident.	_____
Inspection	_____
Intell.	_____
Laboratory	_____
Legal Coun.	_____
Off. of Cong. & Public Affs.	_____
Rec. Mgmt.	_____
Tech. Servs.	_____
Training	_____

b6
b7C

ATTENTION: SUPERVISOR [REDACTED]
EASTERN SERVICE WORKER'S ASSOCIATION (ESWA), NATIONAL LABOR
FEDERATION (NLF); DOMESTIC SECURITY; OO:PH

RE BUREAU CALL OF SUPERVISOR [REDACTED] TO PHILADELPHIA

OCTOBER 6, 1982.

LIMITED DOMESTIC SECURITY INVESTIGATION INITIATED APRIL 12, 1982.

TO EXPIRE OCTOBER 8, 1982.

PHILADELPHIA IS REQUESTING A 90 DAY EXTENSION OF THE LIMITED
INVESTIGATION. CASE AGENT IS CURRENTLY INVOLVED WITH A SPECIAL AND
AN LHM WILL FOLLOW.

BT

100-486889-19
705-293233
OCT 12 1982

DATE 9/18/95 BY SP9 AG/dmy

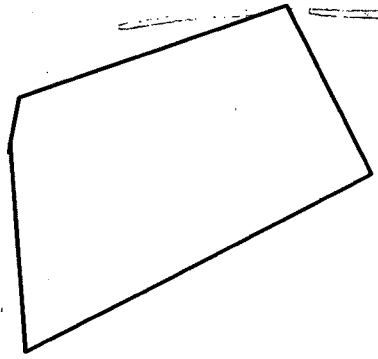

b6
b7C

1004247

FBI

TRANSMIT VIA:

- Teletype
- Facsimile
- Airtel

PRECEDENCE:

- Immediate
- Priority
- Routine

CLASSIFICATION:

- TOP SECRET
- SECRET
- CONFIDENTIAL
- UNCLAS E F T O
- UNCLAS

Date 11/8/82

TO: DIRECTOR, FBI

FROM: SAC, PHILADELPHIA (100-56279) (SQ12) (C)

SUBJECT: EASTERN SERVICE WORKERS ASSOCIATION (ESWA),
 NATIONAL LABOR FEDERATION (NLF);
 DOMESTIC SECURITY
 OO: PHILADELPHIA

PDE-12T

Re Bureau routing slip to Philadelphia, 10/8/82; Philadelphia airtel and LHM to Bureau, 7/7/82.

Enclosed for the Bureau are six copies of an LHM, and for Newark and New York, one copy for information purposes.

Limited Domestic Security Investigation initiated 4/12/82 with extension to expire 1/6/83.

Investigation conducted by the Philadelphia Division during the limited investigation time period of 7/12/82 through 10/9/82, is contained in the attached LHM. Based upon information provided by Philadelphia confidential sources and the Philadelphia Police Department, the Philadelphia Division does not feel ESWA warrants further investigation under the domestic security guidelines. ESWA does not appear to be involved in any activities that relate to a planned overthrow of the U. S. Government, and there have been no discussions of violence or planned violent activities. Furthermore, Philadelphia has been unable to ascertain any relationship between the ESWA and violence-prone groups.

- 3 - Bureau (Encls. 6)
 - 1 - TRAC
 - 1 - Newark (100-57407) (Encl. 1)
 - 1 - New York (229B-87) (Encl. 1)
 - 2 - Philadelphia (SQ12)
 - 1 - 100-56279
 - 1 - 137-9361 (Sub A)

100-486889-20

DE-121

NOV 12 1982

DLJ/ksd
 (7)

ALL INFORMATION CONTAINED
 HEREIN IS UNCLASSIFIED
 DATE 9/18/95 BY SP9 AG/ply/cc

4251
x LHM

Approved: [Signature]

Transmitted _____ (Number) _____ (Time)

Per _____

b6
b7C

Investigation has tended to support the contention that the ESWA is an organization oriented toward providing social reform and assistance programs for the poor. They attempt to provide emergency housing, dental care, and food programs. The Philadelphia Chapter of ESWA contains approximately ten active members who appear to be extremely active in reaching the above goals.

The Bureau should note that all discussions of violence, or association of the ESWA with known violence-prone groups, have come from the National Labor College in New York City. The Philadelphia Chapter appears to be fighting for their financial survival. Investigation will be reinstated immediately if any information comes to the attention of the Philadelphia Division that the ESWA is involved in matters under the domestic security guidelines.

Sources mentioned in the enclosed LHM are as follows:

Confidential Source

Known to the Bureau

"

"

Known to Philadelphia

b6
b7C



U.S. Department of Justice

Federal Bureau of Investigation

In Reply, Please Refer to
File No.

Philadelphia, Pennsylvania

November 8, 1982

EASTERN SERVICE WORKERS' ASSOCIATION (ESWA)/
NATIONAL LABOR FEDERATION (NLF);
DOMESTIC SECURITY

During the course of a limited domestic security investigation on the ESWA/NLF, the Philadelphia Office of the Federal Bureau of Investigation (FBI) has obtained the following information:

The Philadelphia Chapter of the ESWA/NLF is currently located at 1518 South Street, Philadelphia, PA, telephone number (215) 545-9055. The Philadelphia Chapter is oriented toward providing legal and welfare advice, emergency food and clothing, and non-emergency dental care. The ESWA is also actively interested in organizing unrecognized non-union workers, primarily blue collar service workers.

b2
b6
b7C
b7D

Confidential Source [redacted] of known reliability, who is in a position to know, furnished the following information:

Source originally came in contact with the ESWA in July, 1982, when he met [redacted] of the Philadelphia group. Source advised the ESWA is a volunteer service organization, oriented to organizing domestic and service workers. Every Wednesday, classes are held at ESWA on the history of the labor movement. Additionally, ESWA operates on a sporadic basis the National Labor College (NLC) in New York City. The NLC consists of workshops related to discussions on how to organize unrecognized workers not covered by the National Labor Relations Act. The NLC also deals with the history of the Cuban revolution of Fidel Castro, and how to organize workers for a revolution. The NLC has been held at Saint John the Evangelist Church on 21st Street, between

This document contains neither recommendations nor conclusions of the FBI. It is the property of the FBI and is loaned to your agency; it and its contents are not to be distributed outside your agency.

ALL INFORMATION CONTAINED
HEREIN IS UNCLASSIFIED
DATE 9/18/95 BY SP9 AG/dmg

100-486889-20

~~105-210~~ 27

ESWA/NLF

Sixth and Seventh Avenues, Brooklyn, NY. At one NLC meeting, [redacted] [redacted] formerly associated with the Ministry of Health of Nicaragua and a Sandinista, was the guest speaker. The location of NLC is supposed to be confidential, and security guards are present who wear United States (U. S.) style military uniforms.

b6
b7C

The ESWA continues to discuss a planned "revolution" originally set for February 16, 1984; however, the date has been changed to an unknown date. The Philadelphia Chapter operates canvassing drives for new members, and continues to expound on their new plan to help poor people relating to food, clothing, legal advice, and dental care. The owner of the building at 1518 South Street has taken legal action to have ESWA evicted due to non-payment of rent. The Philadelphia Chapter consists of the following active members:

b6
b7C

[redacted]

[redacted]

White/Male

[redacted] [redacted]

White/Female

[redacted]

b6
b7C

[redacted] [redacted]

White/Male

[redacted]

[redacted] [redacted]

Black/Male

[redacted]

[redacted]

White/Male

b6
b7C

PA.

ESWA/NLF

b6
b7C

[redacted]
white/male

[redacted]

[redacted]
white/male

b6
b7C

[redacted]

White/Male

[redacted]

Source reported he attended another NLC meeting held on August 29, 1982, at Our Lady of Mercy Church, 680 Stone Avenue, Brooklyn, NY. Approximately 150 people were in attendance, and it lasted from 2:00 P.M. until 1:00 A.M. About 20 people from the Philadelphia area attended, including [redacted]

b6
b7C

[redacted] (phonetic), described as a Hispanic male with [redacted] mentioned the ESWA has ties with the Teamsters Union and the Irish Republican Army (IRA). No further discussions were held regarding these contacts.

The Philadelphia Chapter of ESWA continues to conduct classes on the labor movement and solicit donations. The money collected is used for the emergency benefits for poor people. Most of the Chapter members reside at ESWA headquarters. Chapter members have also contacted City of Philadelphia politicians in the past attempting to solicit donations, and to insure adequate food, clothing and shelter for poor people.

The Philadelphia Chapter has not discussed any planned violent activities. The group continues to expound on the philosophy of Fidel Castro and Karl Marx at their labor discussions. The Philadelphia Chapter does not appear to be associated with any known violence or terrorist groups.

Confidential Source [redacted] of known reliability and in a position to know, furnished the following information:

b6
b7C

[redacted] of the ESWA has been attempting to solicit donations by speaking at various churches in the Philadelphia suburbs. [redacted] states the ESWA is an organization that

ESWA/NLF

provides free dental exams, lawyers' services through the Coalition of Concerned Legal Professionals, and other basic services for poor people. Source has met [redacted] of ESWA, and both have denied any political affiliation or any idealistic orientation. Source was invited in August, 1982, to attend a meeting at ESWA headquarters in which [redacted] the Eastern Farm Workers Association, and the National Labor Federation, would speak. He declined this invitation. Source was told [redacted] was involved in organizing workers at the I. M. Young Company, Suffolk County, Long Island, NY.

b6
b7C

Source mentioned that about three to four years ago, a cease and desist order was filed by the Commonwealth of Pennsylvania on the organization because they were not registered with the State as a charitable organization. [redacted] told Source this problem was cleared up; however, Source knows that they are not on the list of State charitable organizations.

Source could furnish no information on any violent activities or use of firearms by the ESWA.

FBI

TRANSMIT VIA:

- Teletype
- Facsimile
- AIRTEL

PRECEDENCE:

- Immediate
- Priority
- Routine

CLASSIFICATION:

- TOP SECRET
- SECRET
- CONFIDENTIAL
- UNCLAS E F T O
- UNCLAS

Date _____

TO: DIRECTOR, FBI

ALL INFORMATION CONTAINED
HEREIN IS UNCLASSIFIED
DATE 9/15/95 BY SP9 AG/dmg

FROM: ADIC, NEW YORK (100-182953) (JTF 2) (C)

SUBJECT: EASTERN SERVICE WORKERS ASSOCIATION (ESWA)
NATIONAL LABOR FEDERATION (NLF)
DOMESTIC SECURITY
(OO: PH)

RePHairtel, 11/8/82.

Enclosed for the Bu are six copies of an LHM, and for NK and PH one copy for information purposes.

Limited Domestic Security Investigation initiated 4/12/82, with extension to expire 1/6/82.

100-486889-21 (circled)

Investigation conducted by the NYO to date is contained in the attached LHM. In view of information received from the Suffolk County Police Department and from a former ESWA member the NYO concurs with the PHO in that the ESWA does not warrant further investigation at this time under the Domestic Security guidelines. No activities or plans for violent overthrow of the United States Government have been discovered to date. Additionally the NYO, which is office of origin in the NYROB case, has not found any relationship between the EWSA and the various radical groups involved in NYROB.

- ② - Bureau
- 1 - Newark (Info)
- 1 - Philadelphia (Info)
- 1 - New York

MJF:dsm
(6)

Handwritten notes: 105-215732-1004251 LHM

NOV 30 1982

Approved: [Signature]

Transmitted _____ (Number) _____ (Time)

Per [Signature]

NY 100-182953

The former ESWA member is identified as [redacted]

[redacted] disavowed

[redacted] of any knowledge of arms travel or of militant operations. [redacted] did admit she heard one member talk about the overthrow of the Government because rich people are in charge, but was unable to provide any details since she never heard of or participated in any activities of this type. Continued contact has not been kept with [redacted]

b6
b7C

Investigation by the NYO to date has not been able to disprove that the ESWA is oriented toward helping the migrant farm workers who in the NY area are mainly located in Suffolk County. Membership is found to be approximately 12-15 individuals with recruiting aimed at young adults attending Strong Brooke College in Suffolk County, NY.

Investigation will be reinstated immediately if any information comes to the attention of the NYO that the EWSA is involved in matters under the Domestic Security guidelines.



UNITED STATES DEPARTMENT OF JUSTICE
 FEDERAL BUREAU OF INVESTIGATION
 New York, New York

In Reply, Please Refer to
 File No.

Eastern Service Workers Association
 (ESWA)
 National Labor Federation (NLF)
 Domestic Security

ALL INFORMATION CONTAINED
 HEREIN IS UNCLASSIFIED
 DATE 9/15/95 BY SP9 AG/dmy

During the course of a limited Domestic Security investigation of the ESWA/NLF, the New York Office (NYO) of the Federal Bureau of Investigation (FBI) has obtained the following information:

The New York Chapter of the ESWA/NLF has offices presently located at 58 Beaver Dam Road, Bellport, Long Island, New York (NY); (212) 286-8004 and at 76 West Main Street, Riverhead, Long Island, NY; (212) 727-9380. The philosophy and beliefs professed by the New York Chapter of the ESWA is apparently centered on helping migrant farm workers, low income families, and non-unionized blue collar workers obtain food, medical care, clothing and housing.

Contact was established with the Suffolk County Police Department, which provides police services for the two ESWA locations on Long Island, NY. The Intelligence Unit of the Suffolk County Police Department advised that their information shows the ESWA to be a group aimed at helping migrant farm workers and the poor. The Suffolk County Police Department further reported that there has been no complaints against the ESWA, nor any criminal activities observed or their members suspected of such activity.

Additional information was received from a former member of the ESWA, [redacted] had been involved with the ESWA over a six year period [redacted]

[redacted] advised that during her membership she participated in only three demonstrations, did not participate in any violent or criminal activity, nor did she know of any such incidents. [redacted] stated her motivation to join the ESWA was to help the poor and needy which was in line with her Christian religious beliefs. [redacted] was able to provide the following membership information:

100-486889-21

This document contains neither recommendations nor conclusions of the Federal Bureau of Investigation (FBI). It is the property of the FBI and is loaned to your agency; it and its contents are not to be distributed outside your agency.

105-293232-24
 [Handwritten signature and stamp]

b6
 b7C

Eastern Service Workers Association/National Labor Federation

ESWA-Bellport

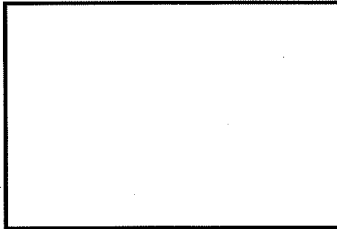

b6
b7C

ESWA-Riverhead

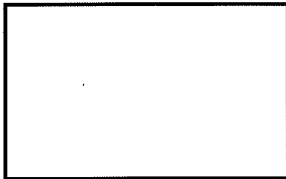

Additional investigation at the NYO, which is the office of origin for the investigation into the October 20, 1981, Brink's Armored Car Robbery, has not revealed any connection between the ESWA and the various radical groups involved in the NYROB incident.

OUTSIDE SOURCE

May 16, 1983

[Redacted]

Dear [Redacted]

Judge Webster has asked me to thank you for your recent letter and kind comments regarding the work of the Bureau. Your interest in writing is certainly appreciated. If you have information which you believe would fall within the investigative purview of the FBI, you may wish to furnish it to a representative of our office located at Gateway 1, Market Street, Newark, New Jersey 07102.

Sincerely,

Roger S. Young
Assistant Director in Charge
Office of Congressional
and Public Affairs

ALL INFORMATION CONTAINED
HEREIN IS UNCLASSIFIED
DATE 9/15/95 BY SP9 AG/bmg

MAILED 15
MAY 17 1983
FBI

DE-143

1 - Newark - Enclosure
Attention SAC: Bufiles contain no identifiable information regarding correspondent.

100-486889-22

- Exec AD Adm. _____
- Exec AD Inv. _____
- Exec AD LES _____
- Asst. Dir.:
- Adm. Servs. _____
- Crim. Inv. _____
- Ident. _____
- Insp. _____
- Intell. _____
- Lab. _____
- Legal Coun. _____
- Off. Cong. & Public Affs. _____
- Rec. Mgnt. _____
- Tech. Servs. _____
- Training _____
- Telephone Rm. _____
- Director's Sec'y _____

NOTE: Correspondent wrote regarding the Eastern Service Workers Association which Bufiles indicate is affiliated with the National Labor Federation and is the subject of a closed Internal Security investigation. (Bufile 105-293232). He indicates that he was a former member; however, he left when it became clear the aim of the group was violent revolution, and a Marxist government in America. He indicates that the information he has to furnish is limited. Letter reviewed by SA [Redacted] Intelligence Division.

CAM: kmf (4)

b6
b7C

b6
b7C

MAIL ROOM

[Redacted]



b6
b7C

2/26

OUTSIDE SOURCE

Dear Director Webster,

I was very pleased at the recent new rules that the Bureau has received.

There is good reason for this, since about two years ago, I joined the Eastern Service Workers, ESWA, and attended some 50 or so meetings. After six months, I grew very dis-satisfied with their Marxist philosophy, especially since they told me, at "national" meetings, that they are convinced violence is the only way to bring about their revolution, and to that end, they have stored arms and munitions, and harbored ex-Weathermen and members of other far-Left groups into an "Armed Faction".

As an old Lefty, I was in sympathy with their anger at unemployment and poverty. But as their plans were revealed to me, I saw that the group I dealt with was not just another political party, but a fanatical group, whose ultimate aims are nothing less than violent revolution, and a Marxist government in America.

Their danger lies in their secret status, and their clever use of American's generosity--they collect over \$5 million dollars every year, by posing as a Mutual Benefits Organization, and promising to attain status as a labor union, as to "organize the unorganized". With the gradual decline of many areas of organized labor, this threat may become very real.

For the past year and some months, I have been sending anonymous letters to civic and religious groups, and local government leaders, exposing the nature of ESWA and other arms of the National Labor Federation, or NATLFED. But this has been risky, and costly; I have travelled over 600 miles posting letters in this time, and spent about \$900. While I have done this of my own free will, and will continue to do so, I would appreciate any help any private citizens could send me,

MAY 23 1983

DATE 9/15/96 BY SP9 AGK/mj

b6
b7C



ACK. 5/16/83
CHM: knf

CONFIDENTIAL

I've been in contact with Sen.

who deserves a great deal of credit. I believe, as the Senator does, that public awareness is one very good way to slow the growth of this group, and others like it. The larger these domestic Parties grow, the more difficult it may be to deal with them in the future, as they use the un-informed mass membership to "help" them in their strategy, and many hundreds or thousands of people may become unwitting dupes of The Party, and may pay severely when their plans for violence become reality.

The evidence that I am offering is limited, for I saw no guns, nor was introduced to anyone admitting to being a wanted fugitive. I have only my experiences, over many months, meeting with perhaps 20 or 30 "Cadre" and "Commisars" of The Party. But I believe the data I was given was accurate-- why should officers of the Provisional Party tell me and others of guns and ordnance they possess, unless these weapons actually exist?

In addition, I was told that active recruitment of armed forces personell was in progress, and steps were being taken to contact federal workers who have access to atomic materials, and workers and scientists in nuclear and weapons research! The danger of this activity is obvious..

In closing, I want to congratulate you and other Bureau members for the efforts you have made. I only hope we are able now to follow through, and bring the full weight of federal law enforcement to bear against the danger that these domestic groups pose to our nation.

Good night, Judge Webster,

God Bless America

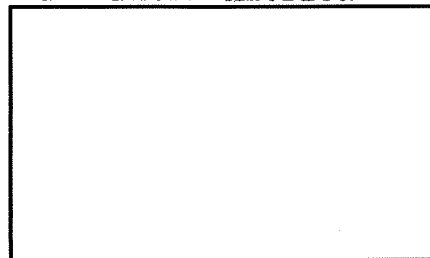

DEPARTMENT OF JUSTICE
FEDERAL BUREAU OF INVESTIGATION
INTERNAL ROUTING/ACTION SLIP

TO	TL #	ROOM	NAME/TITLE	TO	TL #	ROOM	NAME/TITLE
			Exec. AD Adm.				Checking T-124
			Exec. AD Inv.				Classifying T-112
			Exec. AD LES				Consolidation T-125
			Assistant Director:				Filing Unit T-222
			Adm. Serv.				F.O.I.A. T-314
			Crim. Inv.				Numbering T-114
			Ident.				Personnel Rec. T-135
			Intell.				Service Research T-225
			Laboratory				Voucher-Payroll T-153
			Legal Counsel		10955		LFP Pkg. T-324
			Inspection		3239A		Lab. Pkg. T-241
			Rec. Mgmt.		1B327		Mail Room T-152
			Tech. Serv.		7230		NCIC T-245
			Training				Special Inquiry T-231
			Off. of Cong. and Public Affairs				UCR T-244

b6
b7C

5644	[Redacted]	T-211	BY SPECIAL MESSENGER	b6
5835	[Redacted]	T-211	EXPEDITIOUS ATTENTION	b7C
4266	[Redacted]	T-114		
4336	[Redacted]	T-111		
4859	[Redacted]	T-225		
3176	[Redacted]	T-242		

ALL INFORMATION CONTAINED
HEREIN IS UNCLASSIFIED
DATE 9/5/95 BY SP9 AG/dmy

Should you handle

[Redacted]

[Redacted]

b6
b7C

b6
b7C

- Call Me
- See Me
- Approp. Action
- Initial
- Per Inquiry
- Note & Return
- Record & Reply
- See Remarks

FROM

Believes you handled before. Send back to Correspondence Unit if no interest.

ROUTING UNIT

Room 4336 TL # 111 Phone 4765 Date

FILE / *came*

FBI/DOJ